



GLUCOCARD[®] **Expression**[™]

AUDIO-ENABLED BLOOD GLUCOSE MONITORING SYSTEM

User Instruction Manual

Read this User Instruction Manual carefully
before you start testing.

TABLE OF CONTENTS

Introduction	4
Intended Use	5
<i>In Vitro</i> Diagnostic Use	7
The GLUCOCARD® Expression™ System Includes	8
Getting to Know the GLUCOCARD® Expression™ Blood Glucose Meter . . .	9
Meter Display Screen	11
The GLUCOCARD® Expression™ Test Strip	13
GLUCOCARD® Expression™ Control Solution (required)	15
Setting Up Your GLUCOCARD® Expression™ System	16
The Set Up Screen	16
Setting the Clock	18
Setting the Alarms	22
Voice and Beeper Function	24
Voice Function Table	27
Control Solution Testing	33
Performing a Control Solution Test	34

Control Solution Troubleshooting	39
Testing Your Blood Glucose.	40
Preparing Your Lancing Device.	42
Important Information on Alternate Site Testing (AST).	47
Performing a Blood Glucose Test	50
Understanding Your Blood Glucose Test Results	56
Viewing the Meter Memory	58
Caring for the Meter	63
Changing the Battery	64
Cleaning and disinfection procedures for GLUCOCARD® Expression™ meter and Lancing Device	65
Purchase information for DISPATCH® Hospital Cleaner Disinfectant Towels with Bleach	72
Storage and Precautions.	73
Downloading Test Results to a Computer.	74
Solving Problems.	74
Warranty	78
Specifications	79

INTRODUCTION

Thank you for choosing the GLUCOCARD® Expression™ Blood Glucose Monitoring System to help you monitor your diabetes. We designed the GLUCOCARD® Expression™ Blood Glucose Monitoring System to be accurate and easy to use. The added convenience of the bilingual voice feature can be used as a verbal aid for using the meter and hearing test results by visually impaired users. This manual contains all the information needed to use and maintain your new blood glucose meter. Please read carefully before use.

If you have any questions, call ARKRAY Customer Service at 800.566.8558 (24 hours a day, 7 days a week, USA only). Contact your healthcare professional with questions if you are unable to reach Customer Service.

Intended Use

The GLUCOCARD® Expression™ Blood Glucose Monitoring System is intended for the quantitative measurement of glucose in fresh capillary whole blood samples drawn from the fingertips, forearm, or palm. Testing is done outside the body (*In Vitro* diagnostic use). The meter includes voice functionality to assist visually impaired users. It is indicated for lay use by people with diabetes, as an aid to monitoring levels in diabetes mellitus and should only be used by a single patient and it should not be shared. It is not indicated for the diagnosis or screening of diabetes or for neonatal use.

IMPORTANT:

- Dehydration – Severe dehydration may lead to inaccurate blood glucose test results. If you suspect you are severely dehydrated, contact your healthcare professional immediately.
- Hematocrit range – A hematocrit range that is higher than 55% or lower than 30% can cause inaccurate blood glucose test results.
- Not intended for use on neonates.
- Alternate site testing should be performed only during steady-state (when glucose is not changing rapidly). Testing is done outside the body.

***IN VITRO* DIAGNOSTIC USE**

Important Safety Instructions

- The meter and lancing device are for single patient use. Do not share them with anyone, including other family members! Do not use on multiple patients!
- All parts of the kit are considered biohazardous and can potentially transmit infectious diseases, even after you have performed cleaning and disinfection.¹
- Users should wash hands thoroughly with soap and water after handling the meter, lancing device, or test strips.

Links to the public health notification and standard practice guidelines are:

1 "CDC Clinical Reminder: Use of Fingerstick Devices on More than One Person Poses Risk for Transmitting Bloodborne Pathogens" (2010) <http://www.cdc.gov/injectionsafety/Fingerstick-DevicesBGM.html>

THE GLUCOCARD® EXPRESSION™ SYSTEM INCLUDES:

- GLUCOCARD® Expression™ Meter
- User instruction manual
- Carrying case
- Self-testing logbook
- May include test strips, control solution and lancing device and/or lancets

GETTING TO KNOW THE GLUCOCARD® EXPRESSION™ BLOOD GLUCOSE METER

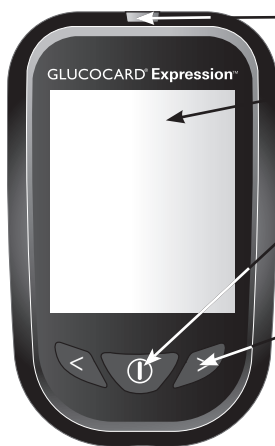

Test Strip Port

Insert test strip (see page 50) to turn on the meter.

Meter Display

Shows your blood glucose test results, memory values, averages, and other messages.

Enter (1) and <> buttons

Press and hold Enter (1) for 2 seconds to turn on or off the meter, or press Enter (1) to go into setup mode when not testing (see page 16).

Press < or > to enter control mode with test strip inserted (see page 33), during meter setup (see page 16), or to navigate the stored test values and averages (see page 58).



Battery Compartment

Holds two AAA batteries

Data Port

Connect an ARKRAY data cable*
here to send data to a PC.

*Purchased separately

METER DISPLAY SCREEN

BATTERY

Appears when batteries need to be changed (see page 64).

CABLE

Indicates the meter is in data transfer mode to PC.

MEM

Indicates the number in the meter display is a stored test value (see page 58).

ALARM

Indicates alarm has been set (see page 22).

CTL

This icon indicates a control solution test (see page 33) or the stored value is a control solution result (see page 62).





BEEPER

Set sound volume (see page 24).

TEMPERATURE

Appears when meter is outside of temperature range (50–104°F).

CLOCK

Indicates the meter is ready to set up time and date (see page 18).

VOICE

Indicates the voice feature is turned on (see page 24).

UNITS

Unit of measurement for blood glucose is mg/dL.

BLOOD DROP and ARROW

Indicates the meter is ready for testing (see page 50).

Displays the date, time, am/pm (in 24-hours format, see page 18), or type of day averages (7, 14, or 30, see page 56).

THE GLUCOCARD® EXPRESSION™ TEST STRIP

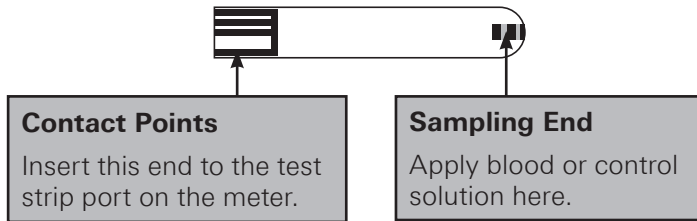

The GLUCOCARD® Expression™ Test Strips require a small blood sample to quickly test glucose in fresh capillary whole blood. The test results are plasma-calibrated for easy comparison to lab results, however results may be 10–15% higher than results obtained from whole-blood referenced blood glucose assays. The test strip is also equipped with under-fill detection to alert you when there is not enough blood to perform a test. This ensures that every reading is accurate and meaningful.

IMPORTANT:

- Immediately close the test strip bottle cap tightly after each use. Keep the unused test strips in the original bottle. DO NOT store any test strips outside the bottle while not in use.
- DO NOT reuse test strips. Test strips are for single use only.
- Carefully discard used test strips and lancets in proper waste containers.

GLUCOCARD® EXPRESSION™ CONTROL SOLUTION (REQUIRED)

GLUCOCARD® Expression™ Control Solution is the standard glucose concentration solution required to perform a glucose control solution test. (See Control Solution Testing—page 33). GLUCOCARD® Expression™ Control Solution is available in 2 levels. GLUCOCARD® Expression™ Control Solution Level 1 (L1) helps you validate the performance of your system for a normal range blood glucose reading. Level 2 (L2) solution helps you validate your system performance for a high range blood glucose reading. Run a control test to make sure the test strips and meter are working together properly, to practice testing procedure, and after opening a new bottle of GLUCOCARD® Expression™ Test Strips.

Call your local supplier or pharmacy to order control solution. If they do not stock the product, please call ARKRAY Order Services at 800.818.8877 (USA only).



SETTING UP YOUR GLUCOCARD® EXPRESSION™ SYSTEM

The Setup Screen

The Setup Screen of the GLUCOCARD® Expression™ meter lets you take advantage of the GLUCOCARD® functions of this meter. To access the Setup Screen:

Step 1: Press and hold Enter (Ⓜ) to turn on meter.

Step 2: Press Enter (Ⓜ) to enter into the Setup Screen.

Step 3: Simply use < > buttons to navigate to the desired function icon, and press the Enter (Ⓜ) button to enter the function when the icon is flashing.

Step 4: Navigate to End at the display screen to exit the Setup Screen. The meter will also announce each function when the voice feature is turned on.



mem

Press Enter (Ⓜ) to enter Memory Recall to retrieve stored results. Your meter stores up to 300 test results with date and time (see page 54).



Press Enter (Ⓜ) to enter PC Link Mode for data transfer onto a PC.



Press Enter (Ⓜ) to enter Time and Date Setup (see page 18).



Press Enter (Ⓜ) to enter Alarm Setup (see page 22). Your meter has 3 alarm settings.



Press Enter (Ⓜ) to enter Volume Setup (see page 25).



Press Enter (Ⓜ) to enter Language Selection (see page 26).

End

Exit Setup Screen and return to testing.



Setting the Clock

You will need:

- Your GLUCOCARD® Expression™ Meter.

NOTE

If date and time on the GLUCOCARD® Expression™ Meter has not been set, test or control result will not be stored in memory.

Step 1: Press and hold Enter (ⓘ) to turn on the meter.

Step 2: Press Enter (ⓘ) to go into the setup screen, then press < or > until ⌚ starts to flash. If the voice function is on, the meter will say, "Set date and time." Press Enter (ⓘ) to enter clock setup.



Step 3: Set the Year. The current year will flash. If the voice function is on, the meter will say, "Set Year." Press < or > to select the correct year. Press Enter (Ⓜ) to confirm your choice. The screen advances to set the month.



Step 4: Set the Month. The current month will flash. If the voice function is on, the meter will say, "Set Month." Press < or > to select the correct month. Press Enter (Ⓜ) to confirm your choice. The screen advances to set the date.



Step 5: Set the Date. The current date will flash. Press < or > to select the correct day. If the voice function is on, the meter will say, "Set Day." Press Enter (Ⓜ) to confirm your choice. The screen advances to the time format setting.



Step 6: Set the Time Format to 12-hour or 24-hour. The current time format will flash. Press < or > to select either 12-hour format or 24-hour format. Press Enter (Ⓜ) to confirm your choice. The screen advances to the hour setting.

Step 7: Set the Hour. The current hour will flash. If the voice function is on, the meter will say, "Set Hour." Press < or > to select the correct hour. Press Enter (Ⓜ) to confirm your choice. The screen advances to the minutes setting.

Step 8: Set the Minute. The current minutes will flash. If the voice function is on, the meter will say, "Set Minutes." Press < or > to select the correct minute. Press Enter (Ⓜ) to confirm your choice and finish setting the clock.



NOTE:

- Anytime during set up, inserting a GLUCOCARD® Expression™ Test Strip will begin testing. Any changes made so far will be stored.
- You may need to reset time after changing batteries.

After date and time has been set, the meter will announce the date and time if the voice feature is on. Begin testing by inserting a GLUCOCARD® Expression™ Test Strip (see page 40—Testing Your Blood Glucose), or press and hold Enter (ⓘ) to turn the meter off. See the next section to set up the alarm feature on your meter.

Setting the Alarms

You can set up to three alarms on the GLUCOCARD® Expression™ meter. You must set the clock before the alarms can be set. When an alarm sounds, the meter turns on, and a melody sounds for 30 seconds. Pressing Enter (ⓘ) or inserting a test strip will silence the alarm. You can set one, two, or all three alarms.

You will need:

Your GLUCOCARD® Expression™ Meter

Step 1: Press and hold Enter (ⓘ) to turn on the meter.

Step 2: Press Enter (ⓘ) to enter setup screen.

Step 3: Press < or > until ⌚ starts to flash. If the voice function is on, the meter will say, "Set Testing Alarm." Press Enter (ⓘ) to enter alarm setting.



Step 4: The display screen will indicate alarm 1 status (the default is OFF). You can turn alarm on or off by pressing < or >.

Step 5: Press Enter (Ⓜ) and the hour will flash. Press < or > to select the hour. Press Enter (Ⓜ) to confirm your choice and the screen advances to the minute setting.

Step 6: The current minutes will flash. Press < or > to select the correct minute. Press Enter (Ⓜ) to confirm your choice. The screen advances to the alarm 2 setting.

Step 7: To set alarm 2 and alarm 3 follow steps 4 through 6. After you have finished setting up alarm 3, press Enter (Ⓜ) to exit alarm setup.

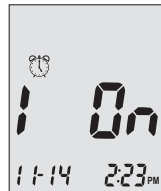

NOTE:

- Alarm will not sound during testing.
- Alarm will follow the time format (12-hour or 24-hour) you choose when setting up the clock.
- Alarm settings will not be erased when changing batteries.

Begin testing by inserting a GLUCOCARD® Expression™ Test Strip (see page 40—Testing Your Blood Glucose), or press and hold Enter (ⓘ) to turn off the meter, or see the next section on how to set up the voice feature on your meter.

Voice and Beeper Function

Your meter has a bilingual voice function that can be used as a verbal aid for using the meter and hearing test results. The default setting for the voice function is on, and can be turned off to conserve battery power. When the voice function is off, the meter will beep to alert you of important messages.

You will need: Your GLUCOCARD® Expression™ Meter

Setting Volume

Step 1: Press and hold Enter (Ⓜ) to turn on the meter.



Step 2: Press Enter (Ⓜ) to go into setup screen. Press < or > until 🔊 starts to flash. Press Enter (Ⓜ) to enter volume setting.

Step 3: The screen displays the current sound volume (default is 2). Press < or > to adjust the sound volume from 1 (lowest) to 5 (highest). A melody will sound according to the sound volume you have selected. Setting to 0 will turn off the voice function. When the voice is turned off, the meter will beep to alert you of important messages. Once you have determined the suitable volume, press Enter (Ⓜ) to exit volume setting.



Language Selection

Step 1: Press and hold Enter (Ⓜ) to turn on the meter.

Step 2: Press Enter (Ⓜ) to enter setup screen.



Step 3: Press < or > until  starts to flash. If the voice function is on, the meter will announce "Language Selection."

Step 4: Press Enter (Ⓜ) to enter the language set up. English is the default language (1 on the display screen) and is announced. Press < or > to select Spanish (2 on the display screen). Press Enter (Ⓜ) when you have finished selecting the language and exit language selection.



NOTE:

- Any time during set up you can insert a GLUCOCARD® Expression™ Test Strip and begin testing. Any changes made so far are stored.
- Your choice of language and volume settings will not be erased when changing batteries.

Begin testing by inserting a GLUCOCARD® Expression™ Blood Glucose Test Strip (see page 40—Testing Your Blood Glucose) or press and hold Enter (ⓘ) to turn off the meter.

Voice Function Table

The voice function can be used as an aid for you to hear the test results and use the meter. The following table lists WHEN the meter will speak and WHAT the meter will say when voice function is turned on.

WHEN the meter will speak...	WHAT the meter will say...
Turned on	Melody
Prompt user to insert test strip	"Please insert test strip"
Test strip is inserted and the meter is ready to test (with flashing arrow and blood drop)	"Blood glucose test. Please apply blood onto the test strip"
Blood glucose test is completed and the result is shown on the screen	"Your blood glucose reading is (number) milligrams per deciliter"
Blood glucose test result is BELOW the measurement range of 20 mg/dL	"Your blood glucose reading is below 20 mg/dL"
Blood glucose test result is ABOVE the measurement range of 600 mg/dL	"Your blood glucose reading is above 600 mg/dL"
Temperature is out of range (between 50–104°F)	"Temperature is out of range"
When the meter is turned off	Melody

Voice Function: Control solution and blood glucose testing
(See page 33—Control Solution Testing and page 40—Testing Your Blood Glucose)

Insert the test strip and press < or >
(**ctl** appears next to the test strip icon)

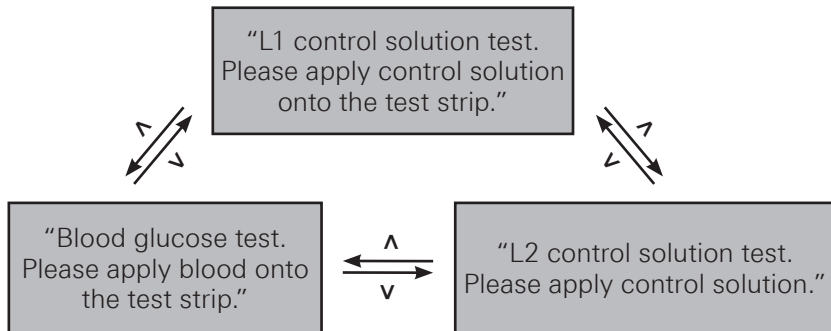

Voice Function: The Setup Screen

(See page 16—Setting Up Your GLUCOCARD® Expression™ System)

Pressing Enter (Ⓜ) to enter setup screen
(after the meter has been turned on)

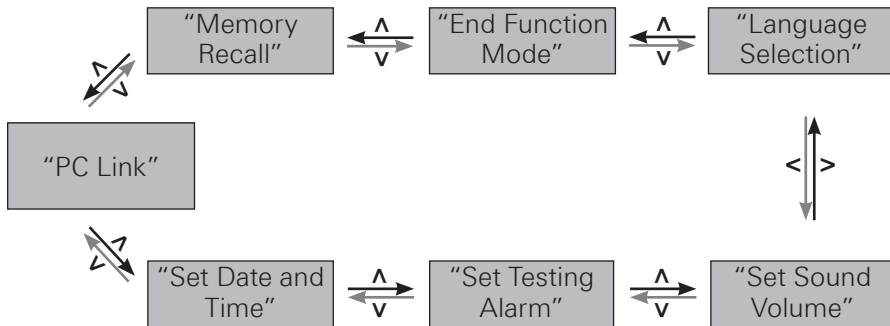

Voice Function: Setting the Clock

WHEN the meter will speak...	WHAT the meter will say...
During date and time setup, setting up the year	"Set Year"
During date and time setup, setting up the month	"Set Month"
During date and time setup, setting up the date	"Set Day"
During time format setup, setting up the time format	"Set 12 Hour, Set 24 Hour"
During date and time setup, setting up the hour	"Set Hour"
During date and time setup, setting up the minutes	"Set Minutes"
After finish setting up date and time	"The date and time is (year) (month) (date) (hour) (minutes)"

Voice Function: Setting the Alarms

WHEN the meter will speak...	WHAT the meter will say...
Setting alarm 1, 2 or 3	"Set Alarm (number)"
When sending data to PC	"Sending data to PC"
Finish sending data to PC	"Data transmission complete"
Voice Function: Other warning messages (See page 76—Solving Problems)	
Meter date and time has not been set	"Please set date and time"
Meter failure	"Error 1 meter failure"
Used test strip	"Error 3 used test strip"
Not enough blood or control solution	"Error 4 not enough sample"

Control Solution Testing

The purpose of the control solution testing is to make sure the GLUCOCARD® Expression™ Meter and the GLUCOCARD® Expression™ Test Strip are working properly. You should perform control solution testing when:

- Using the meter for the first time.
- Using a new bottle of GLUCOCARD® Expression™ Test Strips.
- You left the test strip bottle cap open.
- You dropped the meter.
- You suspect your meter and test strips are not working properly.
- The blood glucose test results do not reflect how you feel.
- You want to practice the testing procedure.

Call your local supplier or pharmacy to order control solution. If they do not stock it, call ARKRAY Order Services at 800.818.8877 (USA only).

Performing a Control Solution Test

IMPORTANT:

- Use only the GLUCOCARD® Expression™ Control Solution with the GLUCOCARD® Expression™ Test Strips. Other brands of control solution will produce inaccurate results.
- Always check the expiration date. DO NOT use control solution if it is expired.
- DO NOT FREEZE. Store the control solution at room temperature.

You will need:

- GLUCOCARD® Expression™ Control Solution (Level 1 or Level 2)
- Your GLUCOCARD® Expression™ meter
- A new GLUCOCARD® Expression™ test strip

Step 1: Remove a GLUCOCARD® Expression™ Test Strip from the test strip bottle. Close the bottle cap immediately. Insert the test strip to turn on the meter.

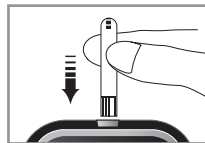

IMPORTANT:

- Check the expiration date printed on the test strip bottle and its package. Do not use expired test strips.
- Use test strip immediately after removing from the bottle.
- Do not use wet or damaged test strips.
- Keep away from direct sunlight and heat. Store the test strip bottle in a dry, cool place.
- Record the “date opened” on the bottle label. Discard the bottle and any remaining test strips after 3 months from date of opening.
- Test under the temperature range of 50–104°F. Your meter will not work outside of this range.
- Must insert test strip into the test strip port.
- Must see a flashing blood drop icon when the test strip has been inserted into the test strip port.

Step 2: Wait until the flashing blood drop and arrow icons appear on the meter display screen. The meter will also announce, “Please apply blood onto the test strip” if you have the voice feature turned on. Press **>** to enter L1 control solution testing.

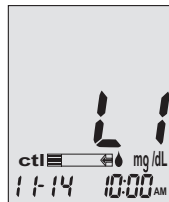

Step 3: **ctl** icon will appear next to the test strip icon and L1 will appear on the meter display screen. The meter will also announce “L1 control solution test, please apply control solution onto the test strip.” If you decide not to do a control solution test, Press **<** until **ctl** disappears from the meter display.

Step 4: Squeeze a drop of control solution onto a clean, dry, non-absorbent surface. Do not apply control solution to the test strip directly from the bottle. Replace the cap on the control solution bottle immediately after use.

Step 5: Gently touch the drop of the control solution to the tip of the test strip. The meter will beep indicating it has received the control solution.

Step 6: The screen will start to count down. After 6 seconds, the control test result will appear on the meter display screen.

Step 7: Compare the reading on the screen to the Level 1 range printed on the test strip bottle or its package. If the reading falls outside the Level 1 range printed on the test strip bottle or its package, see Control Solution Trouble Shooting—page 39.

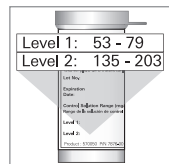
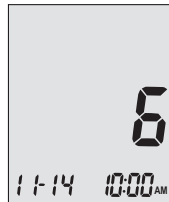

NOTE:

- Control solution test results will be stored into the meter memory and indicated by **ctl** icon.
- Control solution test results will not be used for calculating averages.

Step 8: Remove the used test strip. The meter will automatically turn off. Discard the used test strip into a proper waste container.

IMPORTANT:

Do not re-use test strips.

Follow steps 3 through 8 to complete a Level 2 control solution test and compare the result with the Level 2 range printed on the test strip bottle.

Control Solution Trouble Shooting

If your control solution test is out of range (too high or too low), it may be caused by the following:

Possible Causes	WHAT you can do...
Wrong brand of control solution used	Make sure you are using GLUCOCARD® Expression™ Control Solution.
Control solution not at room temperature	Make sure the testing environment is between 50–104°F.
Expired or contaminated control solution or damaged test strip.	Check the expiration and open bottle date on both the control solution and test strips. Repeat test using a new test strip. If the result is still out of range, use a new bottle of control solution and retest.
Meter malfunction	If problem persists, Please call ARKRAY Customer Service at 800.566.8558 (24 hours a day, 7 days a week, USA only). Contact your diabetes healthcare professional if you cannot reach Customer Service.

Testing Your Blood Glucose

You will need:

- Your GLUCOCARD® Expression™ meter
- A new GLUCOCARD® Expression™ test strip
- Lancing device with a clean, unused lancet (or safety lancets)
- Wide tip (lancing device) for Alternate Site Testing (AST) on palm and forearm

Before you begin, make sure:

- The meter has been set up properly and you've completed a control test. See Setting Up Your GLUCOCARD® Expression™ System—page 16, and Control Solution Testing—page 33 for details.
- Wash your hands and the testing site thoroughly with soap and warm water, dry well.
- You are testing in an area between the temperature ranges of 50–104°F. NOTE: Your meter will not test outside of this range and will display a thermometer icon with verbal indication if the voice feature is turned on. Move the meter into an area that is between 50–104°F, and let sit for 10–15 minutes before testing again.

- If the meter is being operated by a second person who is providing testing assistance to the user, the meter and lancing device should be cleaned and disinfected appropriately when testing is conducted by the second person.

IMPORTANT:

- Check the expiration date printed on the test strip bottle. DO NOT use expired test strips.
- When you open a bottle of test strips for the first time, record the “open date” on the test strip bottle. Discard the bottle and any remaining test strips 3 months after the open date.
- After taking a test strip out of the bottle, close the cap of the bottle immediately.
- Use each test strip immediately after taking it out from the bottle.
- Do not use wet, bent, scratched, or visibly damaged test strips.
- Keep the test strips away from direct sunlight and heat. Store the test strip bottle in a dry, cool place

Preparing Your Lancing Device

For specific lancing device use instructions, see the lancing device insert.

Step 1: Unscrew and remove the adjustable cap

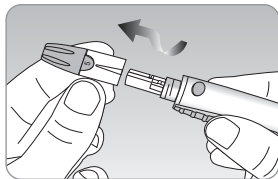

Step 2: Insert a new disposable lancet firmly into the lancet holder. The lancing device cannot puncture at the selected depth when the lancet is not inserted fully. Twist off the protective cover of the lancet and set it aside, then replace the adjustable cap. Keep the protective cover to put on top of the used lancet after testing.

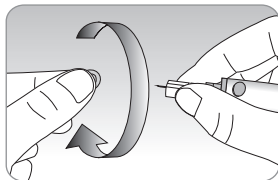
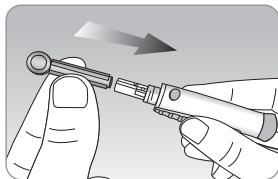

Step 3: The lancing device has multiple puncture depth settings. The smaller numbers are for a shallower puncture and the larger numbers are for a deeper puncture. Choose a depth of penetration by rotating the top portion of the adjustable tip until the setting number matches the arrow. Finer adjustments can be made by setting the arrow between numbers.

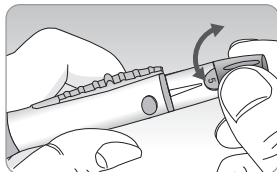

Step 4: Cock the lancing device by holding the body in one hand and pulling on the barrel until a click is heard.

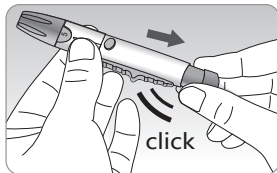

NOTE:

- The skin depth to retrieve samples will vary for various people at different sample sites.
- The lancing device's adjustable cap allows the best depth of skin penetration for an adequate sample size.

CAUTION:

- The lancets are for single use only. Always use a new sterile lancet each time you perform the test.
- DO NOT share your device or lancets with other people. Sharing or reusing lancets can lead to disease transmission.
- Dispose of properly in biohazard waste.
- When performing a blood glucose test, use a new sterile lancet every time. If alcohol wipes are used to cleanse the fingers, make sure the area is dry before the blood sample is obtained.
- Do not use on more than one person. Improper use of blood lancets can increase the risk of inadvertent transmission of bloodborne pathogens, particularly in settings where multiple people are tested. The cleaning and disinfection instructions for this device are intended only to reduce the risk of local use site infection; they cannot render this device safe for use for more than one person.

- Do not draw more blood than necessary for testing.
- Persons younger than 18 years old should be supervised by adults when using the subject device, or adults should perform the procedure on persons younger than 18 years old.
- Risk of injury. If the penetration depth is too deep, the puncture can injure children. Before using the lancing device for the first time on children, ask your healthcare professional. Start with the lowest penetration depth.

Obtaining a Blood Sample

Step 1: Wash hands with soap and warm water and dry thoroughly. Warm water stimulates blood flow to the fingers making it easier to obtain a sample.

Step 2: Hang the arm down at the side for 10 to 15 seconds; massage through the wrist, palm, and then the finger. This can stimulate the blood flow to the finger more quickly.

Step 3: Hold the lancing device (puncture) or lancet against the side of the finger and lance the finger. Follow manufacturer's instruction for how the lancing device (puncture) or lancet should be used.

NOTE:

To avoid soreness, select a site on the side of your fingertips. To avoid calluses, choose a different site each time for obtaining the blood sample.

Important Information on Alternate Site Testing (AST)

The GLUCOCARD® Expression™ Blood Glucose Monitoring System can test blood glucose from areas other than your fingertip such as palm and forearm (alternate site testing, or AST). Alternate site testing can be less painful than fingertip testing, because of the physiological differences between your fingertip, palm and forearm;¹ alternate site test results may be significantly different than results from fingertip testing under certain conditions. You should consult with your doctor or healthcare professional before using an alternate site to test.

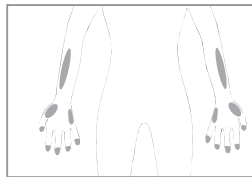

NOTE:

The lancing device included in this box is not intended to be used for Alternate Site Testing (AST).

To obtain a lancing device for AST contact Customer Service: 800.566.8558, 24 hours a day, 7 days a week (USA only).

DO AST ONLY in the following intervals:

- In a pre-meal or fasting state (more than 2 hours since the last meal).
- 2 hours or more after taking insulin.
- 2 hours or more after exercise.

Alternate site measurements should never be used to calibrate continuous glucose monitors (CGMs).

Alternate site measurements should never be used for insulin dosing calculations.

AST SHOULD NOT be used when:

- You are experiencing Hypoglycemic unawareness (unable to tell if you have low blood sugar).
- Within 2 hours of a meal, exercise, or medication.
- You will be operating machinery or driving a car.
- You are sick.
- You think your blood glucose is low.

- Your AST results do not match the way you feel.
- You are testing for hyperglycemia.
- Your routine glucose results are often fluctuating.

NOTE:

- Rubbing forearm until warm before lancing will help minimize the difference between fingertip and AST test results. The palm (at the base of the thumb) does not require rubbing before testing.
- If results from AST do not agree with how you feel, use fingertip testing.

1. Shu M, F, Kazuhiro H, Yoshihito A: Hypoglycemia Detection Rate Differs Among Blood Glucose Monitoring Sites. Diabetes Care 28(3): 708–709, 2005

Performing a Blood Glucose Test

Step 1: Remove a GLUCOCARD® Expression™ test strip from the test strip bottle. Close the bottle cap immediately. Insert the test strip to turn on the meter.

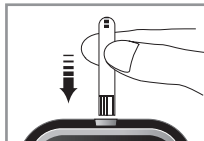

IMPORTANT:

- Check the expiration date printed on the test strip bottle and its package. Do not use expired test strips.
- Use test strip immediately after removing from the bottle.
- Do not use wet or damaged test strips.
- Keep away from direct sunlight and heat. Store the test strip bottle in a dry, cool place.
- Record the “date opened” on the bottle label. Discard the bottle and any remaining test strips after 3 months from date of opening.
- Must insert test strip into the test strip port.
- Must see a flashing blood drop icon when the test strip has been inserted into the test strip port.

Step 2: A flashing blood drop and arrow icon appears on the meter display screen. The meter will announce, “Please apply blood onto the test strip” if you have the voice feature turned on.

Step 3: Obtain blood sample.

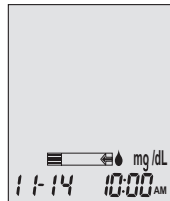

For Fingertip Testing:

Hold the lancing device (use the narrow tip adjustable cap) against the side of your fingertip and press the release button.

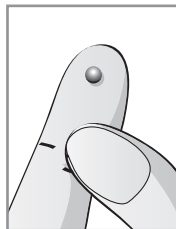
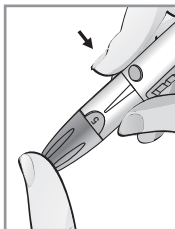

TIP:

- Gently massage your hand and finger toward the puncture site to form a drop of blood (approximate size ●). Do not “milk,” or squeeze around the puncture site.
- Lance the side of your fingertip to avoid soreness. To avoid calluses, choose a different lancing site each time.

For Testing on Palm and Forearm:

Hold the lancing device (use the wide tip adjustable cap) against the test site (base of palm or forearm). Avoid a test site that has veins, moles, excessive hair, or bone.

Press the lancing device firmly against the test site and press the release button, hold lancing device in place.

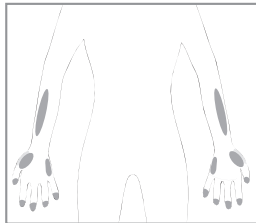

For forearm test sites, apply and release pressure (“pump”) for a few seconds while keeping the lancing device in constant contact with the skin. Palm testing (at the base of the thumb) does not require pumping.

When the blood drop is large enough (approximate size ●), lift the lancing device straight up without smearing the blood drop.



NOTE:

- Rubbing forearm until warm before lancing will help minimize the difference between fingertip and AST test results. The palm (at the base of the thumb) does not require rubbing before testing.
- If results from AST do not agree with how you feel, use fingertip testing.

Step 4: Gently bring the test strip to the drop of blood at a slight angle. The test strip acts like a straw to pull the blood in. Keep the test strip in the blood drop until the meter beeps to indicate the test strip has enough blood.



Step 5: The screen will start to count down. After 6 seconds, your glucose test result will appear on the meter display screen and announce verbally if you have the voice feature turned on. Your test result will be automatically stored into the meter memory.

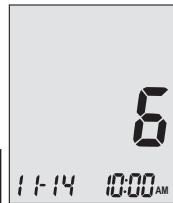

CAUTION:

- If you see **"HI"** or **"LO"** displayed, your blood glucose level may be above 600 mg/dL or below 20 mg/dL. Test again using fingertip testing, DO NOT test on forearm. If you receive the same result, call your physician or healthcare professional immediately.

CAUTION *cont:*

- Wash your hands thoroughly with soap and water after handling the meter, lancing device or test strips.
- Clean and disinfect the meter and lancing device after the test (see cleaning and disinfection).

Step 6: Remove the used test strip into proper waste container. The meter will automatically shut off.

Step 7: Unscrew the lancing device's adjustable cap and place the protective cover on the lancet.

Step 8: Remove lancet and dispose of the used lancet in a proper biohazard container.

IMPORTANT:

You should consult your healthcare provider for instructions on how to properly dispose of used test strip.

Understanding Your Blood Glucose Test Results

Blood glucose values vary depending on food intake, medication, health, stress, and exercise. The ideal range for adults without diabetes:²

- less than 100 mg/dL before meals.
- less than 140 mg/dL after meals.

It is important to consult with your physician or healthcare professional to determine an appropriate target range for you.

High or Low Blood Glucose Readings

If the meter displays results that are HI or LO, or you get a result that is more than 250 mg/dL or below 50 mg/dL AND you feel ill:

- Treat your diabetes according to the instruction from your doctor and/or consult your healthcare provider.

If the meter displays results that are “HI” or “LO,” or you get a result that is more than 250 mg/dL or below 50 mg/dL AND you DO NOT feel ill:

- Test your meter with a control solution, refer to page 33—Control Solution Testing.
- Test again using fingertip testing.

If you still get a high or low reading, contact your healthcare professional.

NOTE:

- Inaccurate results may occur in severely hypotensive individuals or patients in shock.
- Inaccurate low results may occur for individuals experiencing a hyperglycemic-hyperosmolar state, with or without ketosis.
- Critically ill patients should not be tested with blood glucose meters.

Reference:

2. American Diabetes Association Position Statement: Standards of Medical Care in Diabetes—2010. Diabetes Care 2010; 33 (Suppl.1): S11–S61.

Viewing the Meter Memory

Your GLUCOCARD® Expression™ meter automatically stores up to 300 test and control results with date and time. The meter also provides 7-, 14-, and 30-day averaging to help track your blood glucose trends. You must set the date and time on your meter to use the memory and day averaging function (see Setting Up Your GLUCOCARD® Expression™ System—page 16). The meter will not store into memory test or control results if the date and time are not set.

Viewing Stored Readings and 7-, 14-, and 30-Day Average from Memory

You will need:

- Your GLUCOCARD® Expression™ meter

Step 1: Press and hold Enter (Ⓜ) to turn on the meter.

Step 2: Press Enter (Ⓜ) to enter setup screen.

Step 3: Press < or > until **mem** starts to flash. If the voice function is turned on, the meter will say “memory recall.” Press Enter (Ⓜ) to enter. **mem** will appear at the upper left corner of the display memory screen together with your most recent test result. Press < to see the next result, and the next, and so on. Holding < will flash through the test results.



nil will appear on the display screen after the last recorded test result if less than 300 readings are stored. You can press **>** to go back viewing from the oldest to the most recent readings.



Step 4: When you reach the most recent test result, continue to press **>** to start viewing day averages. The meter will display the 7-day average, press **>** again to see the 14-day average, and press **>** again to see the 30-day average.

The number of results included in the average is shown right next to the **DAY AVG** icon. Control solution results are not included in the day average calculations.

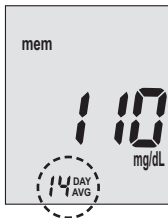
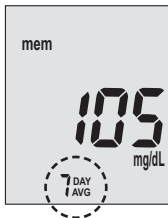

NOTE:

- Control testing results are flagged by **ctl** on the bottom left corner of the display screen in addition to **mem**.
- When the meter memory is blank, the display screen will show **nil**.
- When there is no day average data available, the display screen will show 4 dashes.
- If the meter memory is full, adding a new test result will cause the oldest to be deleted.
- Stored test results and day averages will not be erased when changing batteries.
- You can begin testing anytime by inserting a test strip.

CARING FOR THE METER

Caring for your GLUCOCARD® Expression™ meter is easy. Follow these simple guidelines to keep your meter working properly.

NOTE:

- Do not get water inside the GLUCOCARD® Expression™ meter. Never immerse the meter or hold it under running water.
- Do not use glass or household cleaners on the meter.
- Do not try to clean the test strip holder.
- Do not contaminate the strip holder with blood or control solution.
- Handle the meter with care; severe shock, such as dropping the meter, could damage the electronics.

Changing the Battery

Batteries need to be changed when the  icon appears on the meter display.

Materials you will need:

- Two alkaline AAA batteries
- Your GLUCOCARD® Expression™ meter

Step 1: Press firmly on the battery cover and slide in the direction of the arrow.

Step 2: Insert new batteries. Slide the battery cover back into the meter firmly.



NOTE:

- Meter will prompt you to reconfirm the date and time when turned on. See page 18—Setting the Clock.
- The date, stored results, alarm settings, volume setting, and language choice remain in memory when the batteries are changed.

Cleaning and disinfection procedures for GLUCOCARD® Expression™ meter and Lancing Device

Cleaning and disinfection are different and both should be performed. Cleaning, such as removing dirt with a damp paper towel, is part of your normal care and maintenance, but cleaning does not kill germs effectively. After use and exposure to blood, all parts of this kit can potentially transmit infectious diseases. Disinfection is the only way to reduce your exposure to disease. For cleaning and disinfecting information, see pages 63–72 in this manual.

You should disinfect areas where there are both high concentrations of dangerous germs and a possibility that they will be spread to others. That is because disinfectants have ingredients that destroy bacteria and other germs. While surfaces may look clean, many infectious germs may be lurking around. Given the right conditions some germs can live on surfaces for hours and even for days.

The proper disinfection of GLUCOCARD® Expression™ blood glucose monitoring equipment is using DISPATCH® Hospital Cleaner Disinfectant Towels with Bleach. These are pre-moistened disposable towels for use

in health care and other areas where control of cross contamination is required. Only DISPATCH® wipes have been validated for use in cleaning and disinfection of the meter. A cleaning step must be performed before each disinfection step.

Cleaning and disinfection frequency: The GLUCOCARD® Expression™ meter should be cleaned when it appears dirty or contaminated with blood. It should be disinfected every day according to the validated cycle of 1825 times. The validated cycle of $365 \times 5 = 1825$ times is equivalent to one cleaning plus one disinfection per day over 5 years.

Cleaning and Disinfecting Your Meter

Clean and disinfect your meter at least 1 time per week using DISPATCH® Hospital Cleaner Disinfectant Towels with Bleach, with EPA registration number 56392-8. Other wipes with EPA Reg. No. 56392-8 may also be used.

1. Wash hands with soap and water.
2. Inspect for blood, debris, dust, or lint anywhere on the meter.
3. Clean or disinfect meter.
4. To clean the GLUCOCARD® Expression™ meter, blood/body fluids must be thoroughly cleaned from surface and objects before disinfecting. Dispense the towel (DISPATCH®) from its package. Wipe surface with towel (DISPATCH®) until completely wet. You should wipe all external areas of the meter including both front and back surfaces. Avoid wetting the test strip holder. Allow to remain wet for one minute at room temperature (68–77°F). Discard used towel in a sealed container where it will not be touched by others.



5. To disinfect the GLUCOCARD® Expression™ meter, dispense a second towel (DISPATCH®) from its package. Wipe surface with towel (DISPATCH®) until completely wet. You must wipe all external areas of the meter including both front and back surfaces and allow 1 minute contact at room temperature. Avoid wetting the test strip holder. Wipe dry or allow to air dry. Oily substances must be removed prior to disinfection. Discard used towel in a sealed container where it will not be touched by others.



6. Wash hands with soap and water.

NOTE:

- If the meter is being operated by a second person who is providing testing assistance to the user, the meter should be decontaminated prior to use by the second person.
- Avoid alcohol and ammonia. Even though these two ingredients are excellent disinfectants they are not safe for your meter or lancet device. Alcohol damages the LED read out and ammonia corrodes the metal parts.
- User should wash hands thoroughly with soap and water after handling the meter, lancing device and test strip.
- Keep towels (DISPATCH®) out of reach of children.
- Do not flush towels down toilet.
- Do not get water inside the meter or hold it under running water.
- Do not use glass or household cleaners on the meter.
- Do not try to clean the test strip holder.
- Avoid wetting the test strip holder.
- Only DISPATCH® Hospital Cleaner Disinfectant Towels with Bleach should be used to do cleaning and disinfection with your meter.

Cleaning and Disinfecting Lancing Device

Lancing Device Cleaning and Disinfecting instructions can be found in the lancing device insert.

NOTE:

- If the meter is being operated by a second person who is providing testing assistance to the user, the lancing device should be decontaminated prior to use by the second person.
- The lancing device is for patient self-monitoring by a single person only. It must not be used to collect blood from more than one person as this poses an infection risk.
- User should wash hands thoroughly with soap and water after handling the lancing device.

The list of things you should look for as signs of deterioration after disinfection:

- Control solution out of range
- Clouding of LCD display
- Corroding of plastic housing
- Corroding of buttons
- Malfunction of any meter buttons

If these signs of deterioration are noted, you should stop using the device and call ARKRAY Customer Service at 800.566.8558 (24 hours a day, 7 days a week, USA only).

Purchase Information for DISPATCH® Hospital Cleaner Disinfectant Towels with Bleach

DISPATCH® is the product of Clorox, the catalog number is CLH69150. Below is the list of national distributors and its phone number.

- Medline 800.633.5463
- DNR Supplies..... 763.420.7825

To find a local distributor in your area, call Customer Service at 800.234.7700, M-F, 8:30–5:00 pm EST. You can purchase the DISPATCH® on the web site below:

www.amazon.com, DISPATCH 69150

If you need assistance or have questions about cleaning and disinfection for the meter, please call ARKRAY Customer Service at 800.566.8558 (24 hours a day, 7 days a week, USA only).

STORAGE AND PRECAUTIONS

Storage and Precautions

- The meter and test strips are designed to be used within the temperature range 50–104°F. Do not leave in hot car.
- Avoid leaving the meter in extremely hot or cold places, such as near a heat source or in an extremely hot or cold car.
- Do not store or use the meter or test strips in high humidity levels, such as a bathroom or kitchen.
- Always close the cap of the test strip bottle immediately after removing a test strip and make sure the cap is closed tightly.

DOWNLOADING TEST RESULTS TO A COMPUTER



Test results stored in GLUCOCARD® Expression™ Meter can be transferred from the meter to an electronic logbook via a data cable that connects the meter with a computer or smartphone app.



For more information visit datamanagement.arkrayusa.com or contact Customer Service: 800.566.8558, 24 hours a day, 7 days a week (USA only).



SOLVING PROBLEMS

Please first read this section. If you have questions, call ARKRAY Customer Service at 800.566.8558 (24 hours a day, 7 days a week, USA only). Contact your health care professional with questions if you are unable to reach Customer Service.

If any part of the display screen is missing when the meter is turned on, call ARKRAY Customer Service at 800.566.8558 (USA only).

What you see	What meter says	What it means	What you should do
	"Error 1 meter failure"	The meter electronics or test strip is damaged	<ul style="list-style-type: none"> • Replace the battery and turn on the meter • Remove the test strip and insert a new test strip. • If problem persists, call ARKRAY Customer Service at 800.566.8558 (USA only).
	"Error 3 used test strip"	Used or damaged test strip	<ul style="list-style-type: none"> • Repeat the test with a new test strip. Remember to add sample until you see prompt on the display screen or the meter verbally prompts you to add sample.
	"Error 4 not enough sample"	Not enough sample on the test strip to start	<ul style="list-style-type: none"> • Remove the test strip and repeat the test with a new test strip.

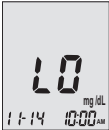
What you see	What meter says	What it means	What you should do
	"Low battery"	Batteries are low	Change the battery (see page 64—Changing the Battery).
	"Temperature is out of range"	Temperature is out of range	Move the meter into an area that is between 50–104°F, and allow 10–15 minutes to reach the new temperature.
	"Your blood glucose reading is above 600 mg/dL"	Test result is higher than 600 mg/dL	Wash and dry your hands and repeat the test on your fingertip with a new test strip. If the result is still "HI," contact your physician or healthcare professional immediately.

What you see	What meter says	What it means	What you should do
	<p>"Your blood glucose reading is below 20 mg/dL"</p>	<p>Test result is lower than 20 mg/dL</p>	<p>Wash and dry your hands and repeat the test on your fingertip with a new test strip. If the result is still "Lo", contact your physician or health care professional immediately.</p>
	<p>NA</p>	<p>There are no stored results in the meter</p>	<p>Check if the date and time on your meter is set. (See Setting Up Your GLUCOCARD® Expression™ System—page 16 and/or Testing Your Blood Glucose—page 40).</p>

Warranty

You are a valued customer of ARKRAY. It is important to us that you are completely satisfied with your GLUCOCARD® Expression™ blood glucose meter.

ARKRAY warrants your GLUCOCARD® Expression™ blood glucose meter will be free from defects in materials and workmanship for a period of five years from the date of the original purchase. If during this time the meter does not work properly because of a defect in materials or workmanship, ARKRAY agrees to replace or repair, free of charge any and all parts proven to be defective and subject to warranty.

This warranty is in lieu of all other warranties, expressed or implied, including any implied warranty of merchantability or fitness for any purpose, other than stated herein.

This warranty does not apply to the performance of the GLUCOCARD® Expression™ blood glucose meter that has been damaged by accident or has been altered, misused, tampered with, or abused in any way. This warranty only applies to the original purchaser of the meter and/or its agents.

Specifications

Test Strips:	GLUCOCARD® Expression™ Test Strips
Test Range:	20–600 mg/dL
Calibration:	Plasma
Test Time:	6 Seconds
Sample Size:	0.8 µL
Hematocrit Range:	30–55%
Display Type:	Large LCD screen
Memory:	300 blood test results with date and time
Result Averaging:	7, 14, and 30 days averaging
Dimension:	93L x 58W x 20.5H (mm)
Weight:	79g
Battery:	2 Alkaline AAA Batteries
Battery Life:	1000 tests of continuous use or 1 year
Automatic Power-off:	After 2 minutes of non-use
Operating Temperature:	50–104°F
Relative Humidity:	20–85%
Storage Condition:	Meter at 39–122°F (4–50°C) Test Strips at 41–86°F (5–30°C) Control Solution: 59–86°F (15–30°C)

For additional information, refer to the GLUCOCARD® Expression™ Test Strip insert.

Distributed By:

ARKRAY USA

8260 NW 27th St, Suite 403

Miami, FL 33122 USA

U.S. Support

800.566.8558

www.arkrayusa.com